

BOROUGH OF OADBY AND WIGSTON

THE BOROUGH OF OADBY AND WIGSTON (OFF-STREET PARKING PLACES) ORDER 2015

The Borough Council of Oadby and Wigston (hereinafter referred to as "the Council") in exercise of their powers under Sections 32 and 35 of the Road Traffic Regulation Act 1984, (hereinafter referred to as "the Act") and of all other enabling powers hereby revoke the Borough of Oadby & Wigston (Off-Street Parking Places) Order 2008 and with the consent of the County Council of Leicestershire given under Section 39(3) of the Act of 1984 and after consulting the Chief Officer of Police in accordance with Part III of Schedule 9 to the Act of 1984, hereby make the following Order:

PART 1

GENERAL

COMMENCEMENT AND CITATION

1. This Order shall come into operation on 1 April 2015 and may be cited as "The Borough of Oadby and Wigston (Off-Street Parking Places) Order 2015". Any references to "this Order" accordingly relates to the "Borough of Oadby and Wigston (Off Street Parking Places) Order 2015"

INTERPRETATION

2.
 - (1) Any reference in this Order to a numbered Article is a reference to the Article bearing that number in this Order, and any reference in this Order to a numbered Schedule is a reference to the Schedule bearing that number in this Order.
 - (2) In this Order words importing one gender shall be treated as importing any gender and words denoting the singular shall include the plural and vice versa.
 - (3) In this Order, except where the context otherwise requires, the following expressions have the meanings hereby assigned to them:-
 - a) "Authorised Officer" means any person authorised by or on behalf of the Council to supervise and enforce the operation of the Parking Place or any

part thereof and includes a Civil Enforcement Officer as defined by Section 76 of the Traffic Management Act 2004.

- b) "Charging Hours" means any period for which a charge is specified for the leaving of a vehicle in a Parking Place by the Council
- c) "Council" means the Oadby and Wigston Borough Council
- d) "Driver" means any person who last operated and controlled the direction and speed of a Vehicle left in a Parking Place or any person that would be deemed to be a Driver under Section 142 of the Act.
- e) "Disabled Person's Badge" means the badge in the form prescribed by any regulations made under Section 21 of the Chronically Sick and Disabled Persons Act 1970 as amended by the Disabled Persons' Parking Badges Act 2013 or any further amendment or re-enactment thereof.
- f) "Disabled Person's Vehicle" means a vehicle lawfully displaying a valid Disabled Persons Badge.
- g) "Goods Vehicle" means a Vehicle constructed or adapted for use for the carriage or haulage of goods.
- h) "Higher Level Contraventions" are as defined in Table 3 of Article 2 of the Schedule of the Civil Enforcement of Parking Contraventions (Guidelines on Levels of Charges) (England) Order 2007 or any amendment or re-enactment thereof.
- i) "Lower Level Contraventions" means all parking contraventions which are not Higher Level Contraventions.
- j) "Motor Car", "Motor Cycle" and "Trailer" have respectively the same meanings as in Sections 136 and 137 of the Act or any amendment or re-enactment thereof.
- k) "Owner" in relation to a vehicle which is required to be licensed under the provisions of the Vehicle Excise and Registration Act 1994 means the person in whose name the vehicle was registered under the Vehicle Excise and Registration Act 1994 Act on the date on which the Vehicle was left in the Parking Place in question.
- l) "Parking Place" means any area of land specified in column 1 of Schedule 1 of this Order provided by the Council for use as a Parking Place under the Act and, for the purpose of identification only, edged red on the plans annexed hereto.
- m) "Parking Bay" means any area of a Parking Place which is provided for the leaving of a Vehicle and which is indicated by markings on the surface of the Parking Place.

- n) "Parking Ticket" means a ticket, card, token or permit displayed in the relevant position and obtained from a Ticket Machine.
- o) "Parking Contravention" in this Order means any contravention of this Order and includes all Parking Contraventions stated in paragraph 4 of part 1 of schedule 7 of the Road Traffic Management Act 2004 or any amendment and enactment thereof.
- p) "Penalty Charge" means a penalty charge relating to a parking contravention and payable in accordance with regulation 4 of the Civil Enforcement of Parking Contraventions (England) General Regulations 2007 or any amendment or re-enactment thereof.
- q) "Penalty Charge Notice" has the meaning given by regulation 8(1) of the Civil Enforcement of Parking Contraventions (England) General Regulations 2007 or any amendment or re-enactment thereof.
- r) "Permit" means any or all types of Permit which may be issued under Article 3 (4) (a) of this Order to a Vehicle or Driver.
- s) "Permit Holder" means any person issued with a Permit under Article 3(4)(a) of this Order.
- t) "Solo Motor Cycle" means a Motor Cycle with two wheels and not being attached to a side car.
- u) "Serve" in respect of a Penalty Charge Notice means the forms of service specified in Regulations 9 and 10 of the Civil Enforcement of Parking Contraventions (England) General Regulations 2007 or any amendment or re-enactment thereof.
- v) "Schedule" shall mean the Schedule attached to this Order.
- w) "In the relevant position" in relation to the display of a Parking Ticket means that the Parking Ticket is positioned in such manner so as to be clearly visible and legible to a reasonable person observing the Vehicle from the front of the Vehicle.
- x) "Ticket Machine" means a device provided by the Council situated in or near to the Parking Place which issues a Parking Ticket whether or not the issue of the Parking Ticket requires the payment of a charge.
- y) "Vehicle" means any Vehicle whether or not it is in a fit state for use on roads, and includes any Motor Car, Motor Cycle, Trailer, caravan or similar and any chassis or body, with or without wheels, appearing to have formed part of such Vehicle and any load carried by, and anything attached to, such Vehicle.

PART II

USE OF PARKING PLACES

3. (1) The area of land specified by name in column 1 of Schedule 1 may be used subject to the following provisions of this Order as a Parking Place for such classes of Vehicles, in such positions, on such days and during such hours as are specified in relation to that area in that Schedule.
- (2) (a) Where in column 2 of Schedule 1 a Parking Place is described as available for Vehicles of a specified class or in a specified position, the Driver of a Vehicle shall not permit the Vehicle to wait in that Parking Place unless it is of the class and in the position specified.

(b) Where a Parking Bay is identified with markings Vehicles must be positioned wholly within the markings of that Parking Bay.

(c) Where within a Parking Place there is a sign or surface marking which indicates that a Parking Bay is available only for a Disabled Persons Vehicle the Driver of a Vehicle shall be in contravention of this Order if they allow a Vehicle to wait in that Parking Bay at any time unless it is a Disabled Persons Vehicle. Failure to comply with this Article shall result in a charge becoming payable as indicated in Schedule 1 to this Order.

(d) Where a Vehicle is parked in a Parking Place during the charging hours and left in such position that a charge is either due upon parking or falls due after any specified time limit has expired, the Driver of the Vehicle shall be in contravention of this Order and liable to the Penalty Charge stated in Column 3 of Schedule 1 for the corresponding Parking Place named in Column 1 of Schedule 1.

(e) Where a Ticket Machine is made available for use at a Parking Place and signage at that Parking Place requires a Parking Ticket to be obtained from the Ticket Machine either at the point of first leaving a Vehicle in a Parking Bay or at some specified time thereafter, the Driver of a Vehicle must display In the relevant position a valid Parking Ticket in accordance with this Order or any such signage displayed at the Parking Place reasonably informing the Driver of such requirement to obtain and display a Parking Ticket.
- (3) (a) Where this Order imposes a time limit on the parking of a Vehicle in a Parking Place within a Parking Bay marked with white lines:-
 - (i) That Vehicle may be left in that Parking Place on one occasion only on any one day except Sundays and Bank Holidays.

- (ii) It shall be an offence for the Driver of that Vehicle to leave it in that Parking Place on a second or subsequent occasion on any one day except Sundays and Bank Holidays.
 - (iii) The fee for parking a Vehicle in that Parking Place shall be that stated in Column 3 of Schedule 1 for the corresponding Parking Place in Column 1 of Schedule 1 in which the Vehicle is left.
- (b) Where this Order imposes a time limit on the parking of a Vehicle in a Parking Place within a Parking Bay marked with green lines:-
 - (i) That Vehicle may be left in that Parking Place on one occasion only on any one day except Sundays and Bank Holidays.
 - (ii) It shall be an Offence for the Driver of that Vehicle to leave it in that Parking Place on a second or subsequent occasion on any one day except Sundays and Bank Holidays.
 - (iii) The fee for parking a Vehicle in that Parking Place shall be that stated in Column 3 of Schedule 1 for the Parking Place listed in Column 1 of Schedule 1 in which the Vehicle is left.
- (4) (a) The Council may issue a Permit to a Permit Holder allowing that Permit Holder to leave a Vehicle in a specified Parking Bay within a specified Parking Place in consideration for such fee as may be determined by the Council and as may be published by the Council annually or from time to time in its scale of charges and on such terms and conditions as the Council thinks reasonable. The Council may establish such scheme as it thinks reasonable to determine the allocation of Parking Permits for designated Parking Places or for designated Parking Bay's within Parking Places.
- (b) If at any time in a Parking Place there is displayed a notice or other indication is given that a Parking Bay is reserved for (1) use by a Permit Holder, (2) leaving Solo Motorcycles (3) any other specified or unspecified use, no person shall leave a Vehicle in any such Parking Bay other than for the purpose for which the Parking Bay is reserved. Failure to comply with this Article shall result in a Penalty Charge becoming payable as indicated in Schedule 1 of this Order.
- (c) The Driver of a Motor Vehicle which displays in the relevant position a Disabled Persons Badge and whose Vehicle is parked as specified in Article 3(2)(c) of this Order shall be exempt from any payment or charge specified in Schedule 1 of this Order for a period of such time as may be stated in that Schedule but shall not be exempt from any other provision of this Order.

RESTRICTIONS ON USE OF PARKING SPACES

4.
 - (1) The Owner or Driver of a Vehicle shall not permit that Vehicle to wait in a Parking Place unless that Vehicle is licensed in pursuance of the provisions of the Vehicle Excise and Registration Act 1994 and unless there is in relation to the use of the Vehicle by the Driver a policy of insurance that complies with the requirements of Part VI of the Road Traffic Act 1988.
 - (2) The Driver of a Vehicle using the Parking Place shall stop the engine as soon as the Vehicle is in position in the Parking Place within a Parking Bay and shall not start the engine except when about to change the position of the Vehicle, in, or to depart from, the Parking Place.
 - (3) No person shall use any part of a Parking Place or any Vehicle left in a Parking Place:-
 - a) For sleeping, camping, eating or cooking; or
 - b) For the purpose of servicing, washing, cleaning, constructing, maintaining or repairing any vehicle or part thereof other than is reasonably necessary to enable that vehicle to depart from the parking place; or
 - c) For washing any part of his person.
 - (4) The Driver of a Vehicle using the Parking Place shall not sound any horn or other similar instrument except for the purpose of warning in an emergency.
 - (5) No person shall ride on or otherwise use a skateboard or use roller-skates in the Parking Place.
 - (6) No person shall use a Vehicle while it is in a Parking Place, in connection with the sale of any article (including the Vehicle itself) to persons in or near the Parking Place or in connection with the selling or offering for hire of his skill or services, unless expressly authorised to do so in writing by the Council.
 - (7) No person shall use a Parking Place for the storage of a Vehicle for any purpose.
 - (8) No person shall transfer goods of any description, other than articles of a personal nature such as a travelling bag, from one Vehicle to another while one or both of the Vehicles are parked in a Parking Place.
 - (9) No person shall in a Parking Place wantonly shout or otherwise make any loud noise to the disturbance or annoyance of users of the Parking Place or residents of premises in the neighbourhood.

- (10) No person shall in a Parking Place destroy, damage, interfere with or deface any property belonging to the Council, and in addition to liability for any penalty imposed for a breach of this provision of this Order, any person so doing shall be liable for and shall pay the Council the full cost of repair of the damage.
- (11) No person shall in a Parking Place use threatening, insulting or abusive language gesture or conduct with intent to put any person in fear or so as to occasion a breach of the peace or whereby a breach of the peace is likely to be occasioned.
- (12) A person who is not in a Parking Place for the purpose of parking or retrieval of a Vehicle or for a purpose connected therewith on being requested to leave the Parking Place by an Authorised Officer and shall do so forthwith.
- (13) In a Parking Place no person shall:-
- a) Erect or cause to be erected any tent, booth, stand, building or other structure without the written consent of the Council;
 - b) Light or cause or permit to be lit any fire, stove or cooker.
- (14) The Driver of a Vehicle drawing a Trailer shall not permit the Vehicle or the trailer to wait in a Parking Place unless they have been disconnected, and for the purposes of this Order the Vehicle and the Trailer shall be deemed to be separate Vehicles and the said Driver shall be deemed to be the Driver of each of the said Vehicles.

Movement, removal and disposal of vehicle left in a Parking Place

5. (1) If a Vehicle is left in a Parking Place in a position other than in accordance with the provisions of Article 3, a person authorised by the Council may alter or cause to be altered the position of the Vehicle so that it accords with the requirements of Article 3.
- (2) If a Vehicle is left in a Parking Place in contravention of any of the provisions of this Order a person authorised by the Council may remove the Vehicle from the Parking Place or arrange for its removal.
- (3) For the purpose of meeting the requirements of an emergency a person authorised by the Council or a Police Constable may alter or cause to be altered the position of a Vehicle in a Parking Place or remove or arrange for the removal of a Vehicle from a Parking Place.
- (4) Any person altering, or causing the alteration of, the position of a Vehicle by virtue of paragraph (1) of this Article, or removing, or causing the removal of, a Vehicle by virtue of paragraphs (2) or (3) of this Article, may do so by

towing or driving the Vehicle or in such other manner as he think reasonably necessary to enable the position of the Vehicle to be altered or the Vehicle to be removed.

- (5) Any person removing or arranging for the removal of a Vehicle by virtue of paragraphs (2) or (3) of this Article shall make such arrangements as he considers to be reasonably necessary for the safety of the Vehicle in the place to which it is removed.
- (6) Any reasonable costs incurred by the Council in the exercise of the powers contained in paragraphs (1) (2) (4) and (5) of this article may be recovered from the Owner or Driver of the Vehicle concerned and the Council may retain possession of the Vehicle until such costs are paid in full.
- (7) Section 102 of the Act shall apply to this Order in respect of the recovery by the Council of the charges for the moving or removal of Vehicles in accordance with this Article.
- (8) Where in a Parking Place signs are erected or surface markings are laid for the purpose of:-
 - (a) Indicating the entrance to or exit from the Parking Place, prohibiting entry or exit, or
 - (b) Indicating that a Vehicle using the Parking Place shall proceed in a specified direction within the Parking Place, or
 - (c) Indicating the Parking Bays within which a Driver may leave a Vehicle.

No Driver shall drive a Vehicle;

- (i) so that it enters the Parking Place otherwise than by an entrance, or leaves the Parking Place otherwise than by an exit so indicated,
 - (ii) in a direction other than so specified,
 - (iii) or enters or exits the Parking Place in contravention of a sign prohibiting entry or exit, or
 - (iv) so that it is left otherwise than within a Parking Bay.
- (9) No person shall, except with the permission of a person authorised by the Council drive or allow to be driven any Vehicle in a Parking Place for any purpose other than the purpose of leaving that Vehicle in the Parking Place, in accordance with the provision of this Order, or for the purpose of departing from the Parking Place.

- (10) No person shall use a Parking Place as a means of passage for a Vehicle to proceed from one road to another road unless markings on the surface of the Parking Place or signs indicate that this is permissible.
- (11) No person shall drive in a Parking Place in a direction contrary to that indicated by any markings, signs or arrow on the surface of the Parking Place or displayed clearly within the Parking Place.
- 6. The provisions of the Refuse Disposal (Amenity) Act 1978 and Removal and Disposal of Vehicles Regulations 1986 and any amendment or re-enactment thereof shall be incorporated herein and form part of this Order so that:-
 - (1) No person shall within any Parking Place do anything which if the Parking Place were land in the open air would constitute an offence under either the Act or Regulations stated in this Article.
 - (2) The Council may dispose of a Vehicle abandoned in any Parking Place in accordance with the provisions of either the Act or Regulations stated within this Article.
- 7. Where an Authorised Officer has reason to believe that a Vehicle has been left or permitted to remain at rest contrary to the provisions of this Order he or another person acting under his discretion may fix an immobilisation device to the Vehicle concerned while it remains in the place where it was found in accordance with the provisions of Part 3 of the Civil Enforcement of Parking Contraventions (England) General Regulations 2007 and any other powers so enabling the fixing of an immobilisation device or any amendment or re-enactment thereof.

Penalty Charge for Use of Parking Places

- 8.
 - (1) Any contravention or non-compliance with any provision of this Order by the Driver will result in the issuing of and liability for a Penalty Charge as detailed in Schedule 1 of this Order. In the case of a Vehicle in respect of which a Penalty Charge Notice has been incurred an Authorised Officer shall Serve the Penalty Charge Notice.
 - (2) The particulars given in the Penalty Charge Notice attached to a Vehicle in accordance with this Article shall be treated as evidence in any proceedings relating to failure to pay such a Penalty Charge.
 - (3) The Penalty Charge Notice shall give a time limit in which the Penalty Charge Notice must be paid and shall offer the Driver the option of a reduced Penalty Charge if paid within 14 days following the date of issue endorsed on the Penalty Charge Notice.

- (4) If a Penalty Charge is not paid within 28 days or any later date that may be set by The Civil Enforcement of Parking Contraventions (Guidelines on Levels of Charges) (England) Order 2007 or any amendment or re-enactment thereof the Council may take such further action as permitted by those regulations in respect of the Driver or the Owner of the Vehicle.
- 9. The reduced Penalty Charge shall be the charge set by the Secretary of State under the provisions of Section 77 and Schedule 9 of the Traffic Management Act 2004 and The Civil Enforcement of Parking Contraventions (Guidelines on Levels of Charges) (England) Order 2007 or any amendment or re-enactment thereof and is to be paid within 14 days
- 10. In the event of the Driver failing to pay a Penalty Charge within the period stipulated in the Civil Enforcement of Parking Contraventions (England) General Regulations 2007, or any amendment or re-enactment thereof, the Council may give notice in writing to the Owner of the Vehicle in respect of which the Penalty Charge was incurred in accordance with those Regulations requiring the Owner to supply the identity of the Driver.

Restrictions on Removal of a Penalty Charge Notice

- 11. When a Penalty Charge Notice has been attached to a Vehicle in accordance with any provision of this Order no person other than a person authorised by the Council or the Driver or a person authorised by the Driver shall remove the Penalty Charge Notice from the Vehicle

Prohibition on use of Parking Places

- 12.
 - (1) Where an Owner or Driver has incurred liability to pay a Penalty Charge and the Penalty Charge remains unpaid for a period of two months from the date when a Penalty Notice was attached to a Vehicle in accordance with Article 8(1), the Council may prohibit the Owner or Driver of that Vehicle from leaving any Vehicle within a Parking Place.
 - (2) The Council shall first give at least 7 days notice in writing to the Owner or Driver of a Vehicle at the last known address of the Owner or Driver before the prohibition stated in Article 12(1) comes into effect.
 - (3) A person subject to a prohibition under Article 12(1) shall be deemed to have contravened this Order if they leave any Vehicle within a Parking Place at any time whilst prohibited from doing so by the Council and shall be liable to a further Penalty Charge as if the Vehicle had been parked in contravention of Article 3.

- (4) The prohibition on leaving a Vehicle in a Parking Place under Article 12(1) shall be removed by the Council upon payment of all outstanding liability by an Owner or Driver unless the Council deems it reasonable that such prohibition remains.

General Provisions

13. Without prejudice to its powers under this Order to recover any charges or payments due to the Council in proceedings before the Magistrates' Court, the Council shall have the power to recover any such charge or payment in the County Court as if it were a civil debt.
14. Where Schedule 1 provides a time period within which a Vehicle may be left in Parking Place without charge that time period shall be construed as either beginning when first observed by an Authorised Officer or at the time stated on any Parking Ticket whichever is the earlier.
15. Where double or hatched Yellow Lines or both are marked upon the surface of a Parking Place a Driver of a Vehicle will contravene this Order if they allow a Vehicle to park or wait on, over or adjacent to such markings.
16. It shall be an offence to fail to comply forthwith with a request of an Authorised Officer of the Council which is made for the purpose of securing compliance with any provision of this Order.
17. Contravention of or non-compliance with any of the provisions of this Order shall be an offence in accordance with Section 35A of the Act.
18. Any person committing a Parking Contravention detailed in this Order will be liable to the Penalty Charge stated in Table 1 of the Article 2, paragraph 2 of the schedule of the Civil Enforcement of Parking Contraventions (Guidelines on Levels of Charges) (England) Order 2007 or any amendment or re-enactment thereof.
19. The Council shall not be responsible for any loss or damage to any Vehicle or any of the contents which may occur while the Vehicle has been left in a Parking Place or while the position of the Vehicle is being altered in accordance with Article 5.

Power of the Council to Close Parking Places

19. (1) Nothing in this Order shall restrict the power of the Council to suspend the operation of a Parking Place or any part thereof and when the operation of the Parking Place or part thereof is suspended, the Council shall display a notice or notices to that effect at the Parking Place.

- (2) When the operation of the Parking Place is suspended pursuant to paragraph (1) of this Article, no person shall cause any Vehicle to enter, stand, wait or be left in the Parking Place or any part thereof, for the duration of the suspension without the written authorisation of the Council.
- (3) The Owner or Driver of an ambulance, police vehicle or fire and rescue service vehicle will not be in contravention of Article 19(1) of this Order if during the suspension they enter a Parking Place or leave their vehicle at any time in the Parking Place in order to carry out their legitimate public duties.
- (4) The Owner or Driver of a Vehicle will not be in contravention of Article 19(1) of this Order if during the suspension they enter a Parking Place or leave their Vehicle within a Parking Place under the direction of a Police Constable carrying out his legitimate public duties or where the Owner or Driver is a Permit Holder authorised to park in that Parking Place.
- (5) If at any time the Council require a Parking Place or part thereof for any purpose whatsoever (including its use as a private Parking Place in connection with a particular event) the right of any person to enter or leave a Vehicle thereon shall immediately terminate until such time as the Council no longer require the Parking Place or part thereof.

The Common Seal of OADBY AND

WIGSTON BOROUGH COUNCIL

was hereto affixed this day of in the year

MAYOR:

HEAD OF CORPORATE RESOURCES:

The Borough of Oadby and Wigston (Off-Street Parking Places) Order 2015

Schedule 1

| Name of Parking Place 1 | Classes of Vehicle and position in which vehicle may wait and maximum waiting period 2 | Scale of Charges during charged hours 3 |
|---|--|--|
| <p>East Street / Brooksby Drive Car Park, Oadby</p> | <p>Motor cars licensed as private, or private/light goods vehicles not exceeding 3500 kg unladen weight and 2 metres in height, sole motor cycles, motor cycles with sidecars and disabled persons vehicles.</p> <p><u>White Lined bays</u> Up to 3 hours Monday to Saturday (inclusive) between the hours of 8 a.m. and 6 p.m except public holidays</p> <p><u>Green Lined bays</u> Up to 20 minutes:, Monday to Saturday (inclusive) except public holidays, no period of parking on the parking place to exceed 20 minutes between the hours of 8 a.m. and 6 p.m.</p> | <p>Free up to 3 hours or such charge as may be specified by the Council in its scale of charges and advertised at the Parking Place for any duration thereafter.</p> <p><u>Penalty charges for any contravention of this Order.</u></p> <p>Set at band 2 of Table 1 of paragraph 2 of Article 2 of the Civil Enforcement of Parking Contraventions (Guidelines on Levels of Charges) (England) Order 2007 or re-enactment thereof.</p> <p>Reduced Penalty Charge if paid within 14 days.</p> <p>Increased Penalty Charge after Service of Charge Certificate.</p> <p>Free up to 20 minutes or such charge as may be specified by the Council in its scale of charges and advertised at the Parking Place for any duration thereafter.</p> <p><u>Penalty charges for any contravention of this Order.</u></p> <p>Set at band 2 of Table 1 of paragraph 2 of Article 2 of the Civil Enforcement of Parking Contraventions (Guidelines on Levels of Charges) (England) Order 2007 or re-enactment thereof.</p> <p>Reduced Penalty Charge if paid within 14 days.</p> <p>Increased Penalty Charge after Service of Charge Certificate.</p> |

| | | |
|---|---|---|
| East Street / Brooksby Drive Car Park, Oadby (designated area in north-eastern corner only) | In respect of that part of the north-eastern corner of the Parking Place, Monday to Saturday (inclusive), motor vehicles or vehicle combinations exceeding 3500 kg unladen weight shall be permitted to park for a maximum period of twelve hours between 7 p.m. and 7 a.m. only. | <p>Free up to 12 hours or such charge as may be specified by the Council in its scale of charges and advertised at the Parking Place for any duration thereafter.</p> <p><u>Penalty charges for any contravention of this Order.</u></p> <p>Set at band 2 of Table 1 of paragraph 2 of Article 2 of the Civil Enforcement of Parking Contraventions (Guidelines on Levels of Charges) (England) Order 2007 or re-enactment thereof.</p> <p>Reduced Penalty Charge if paid within 14 days.</p> <p>Increased Penalty Charge after Service of Charge Certificate.</p> |
| <p>Ellis Park Car Park, Oadby</p> <p>Frederick Street Car Park, Wigston</p> <p>Junction Road Car Park, Wigston</p> <p>Spring Lane Car Park, Wigston</p> | <p>Motor cars licensed as private, or private/light goods vehicles not exceeding 3500 kg unladen weight and 2 metres in height, sole motor cycles, motor cycles with sidecars and disabled persons vehicles.</p> <p><u>All Parking Bays</u></p> <p>Short stay: up to 3 hours Monday to Saturday (inclusive) between the hours of 8 a.m. and 6 p.m. except public holidays</p> | <p>Free up to 3 hours or such charge as may be specified by the Council in its scale of charges and advertised at the Parking Place.</p> <p><u>Penalty charges for any contravention of this Order.</u></p> <p>Set at band 2 of Table 1 of paragraph 2 of Article 2 of the Civil Enforcement of Parking Contraventions (Guidelines on Levels of Charges) (England) Order 2007 or re-enactment thereof.</p> <p>Reduced Penalty Charge if paid within 14 days.</p> <p>Increased Penalty Charge after Service of Charge Certificate.</p> |
| <p>Sandhurst Street Car Park, Oadby</p> <p>Aylestone Lane Car Park, Wigston</p> <p>Paddock Street Car Park, Wigston</p> | <p>Motor cars licensed as private, or private/light goods vehicles not exceeding 3500 kg metric tonnes unladen weight and 2 metres in height, sole motor cycles, motor cycles with sidecars and disabled persons vehicles.</p> <p><u>All Parking Bays</u></p> | |

| | | |
|--|--|---|
| | <p>Short stay: up to 3 hours Monday to Saturday (inclusive) between the hours of 8 a.m. and 6 p.m. except public holidays</p> <p>Long stay: over 3 hours Monday to Saturday (inclusive) except public holidays, no period of parking in the Parking Place to exceed twelve hours on any day. Charges operative between 8 a.m. and 6 p.m. daily except Sundays and public holidays.</p> | <p>Free up to 3 hours or such charge as may be specified by the Council in its scale of charges and advertised at the Parking Place for any duration thereafter.</p> <p><u>Penalty charges for any contravention of this Order.</u></p> <p>Set at band 2 of Table 1 of paragraph 2 of Article 2 of the Civil Enforcement of Parking Contraventions (Guidelines on Levels of Charges) (England) Order 2007 or re-enactment thereof.</p> <p>Reduced Penalty Charge if paid within 14 days.</p> <p>Increased Penalty Charge after Service of Charge Certificate.</p> <p>Such charge as may be specified by the Council in its scale of charges and advertised at the Parking Place for any duration thereafter.</p> <p><u>Penalty charges for any contravention of this Order.</u></p> <p>Set at band 2 of Table 1 of paragraph 2 of Article 2 of the Civil Enforcement of Parking Contraventions (Guidelines on Levels of Charges) (England) Order 2007 or re-enactment thereof.</p> <p>Reduced Penalty Charge if paid within 14 days.</p> <p>Increased Penalty Charge after Service of Charge Certificate.</p> |
| <p>Oadby:</p> <p>Brocks Hill Environment Centre, Car Park</p> <p>Coombe Park Car Park</p> <p>Parklands Leisure Centre Car Park</p> <p>St Peters Church Hall Car Park, Wigston Road</p> <p>Uplands Park Car Park</p> <p>Walter Charles Centre Car Park</p> | <p>Motor cars licensed as private, or private/light goods vehicles not exceeding 3500 kg unladen weight and 2 metres in height, sole motor cycles, motor cycles with sidecars and disabled persons vehicles</p> <p>At any time within the parking place or within the individual spaces from time to time marked on the surface of the parking place. No period of parking to exceed 12 hours on any day, except on issue of a permit.</p> | <p>Free up to 12 hours or such charge as may be specified by the Council in its scale of charges and advertised at the Parking Place for any duration thereafter.</p> <p><u>Penalty charges for any contravention of this Order.</u></p> <p>Set at band 2 of Table 1 of paragraph 2 of Article 2 of the Civil Enforcement of Parking Contraventions (Guidelines on Levels of Charges) (England) Order 2007 or re-enactment thereof.</p> <p>Reduced Penalty Charge if paid within 14 days.</p> |

| | | |
|---|---|---|
| <p>Wigston: Freer Community Centre Car Park</p> <p>Horsewell Lane Recreation Ground Car Park</p> <p>Peace Memorial Park Car Park</p> <p>Wigston Cemetery Car Park</p> <p>Wigston Pool Car Park</p> <p>Willow Park Car Park</p> <p>South Wigston: Blaby Road Park Car Park,</p> <p>Countesthorpe Road Car Park</p> <p>Kirkdale Road Car Park</p> <p>Station Street Car Park.</p> | | <p>Increased Penalty Charge after Service of Charge Certificate.</p> |
| <p>Council Offices Car Park, Station Road, Wigston</p> <p>Oadby Depot Car Park, Off Wigston Road, Oadby</p> | <p>Motor cars licensed as private, or private/light goods vehicles not exceeding 3500 kg metric tonnes unladen weight and 2 metres in height, sole motor cycles, motor cycles with sidecars and disabled persons vehicles.</p> <p>Designated visitor and Disabled Vehicle Parking Bays – not to exceed 3 hours except on issue of a permit.</p> | <p>Free up to 3 hours or such charge as may be specified by the Council in its scale of charges and advertised at the Parking Place for any duration thereafter.</p> <p><u>Penalty charges for any contravention of this Order.</u></p> <p>Set at band 2 of Table 1 of paragraph 2 of Article 2 of the Civil Enforcement of Parking Contraventions (Guidelines on Levels of Charges) (England) Order 2007 or any amendment or re-enactment thereof.</p> <p>Reduced Penalty Charge if paid within 14 days.</p> <p>Increased Penalty Charge after Service of Charge Certificate.</p> |

Aylestone Lane Car Park



1:500

This map is based upon Ordnance Survey material with the permission of Ordnance Survey on behalf of the Controller of Her Majesty's Stationary Office. Crown copyright. Unauthorised reproduction infringes crown copyright and may lead to prosecution or civil proceedings. Gately & Wignall Borough Council 2014. Licence No. 100023263

Blaby Road Park Car Park

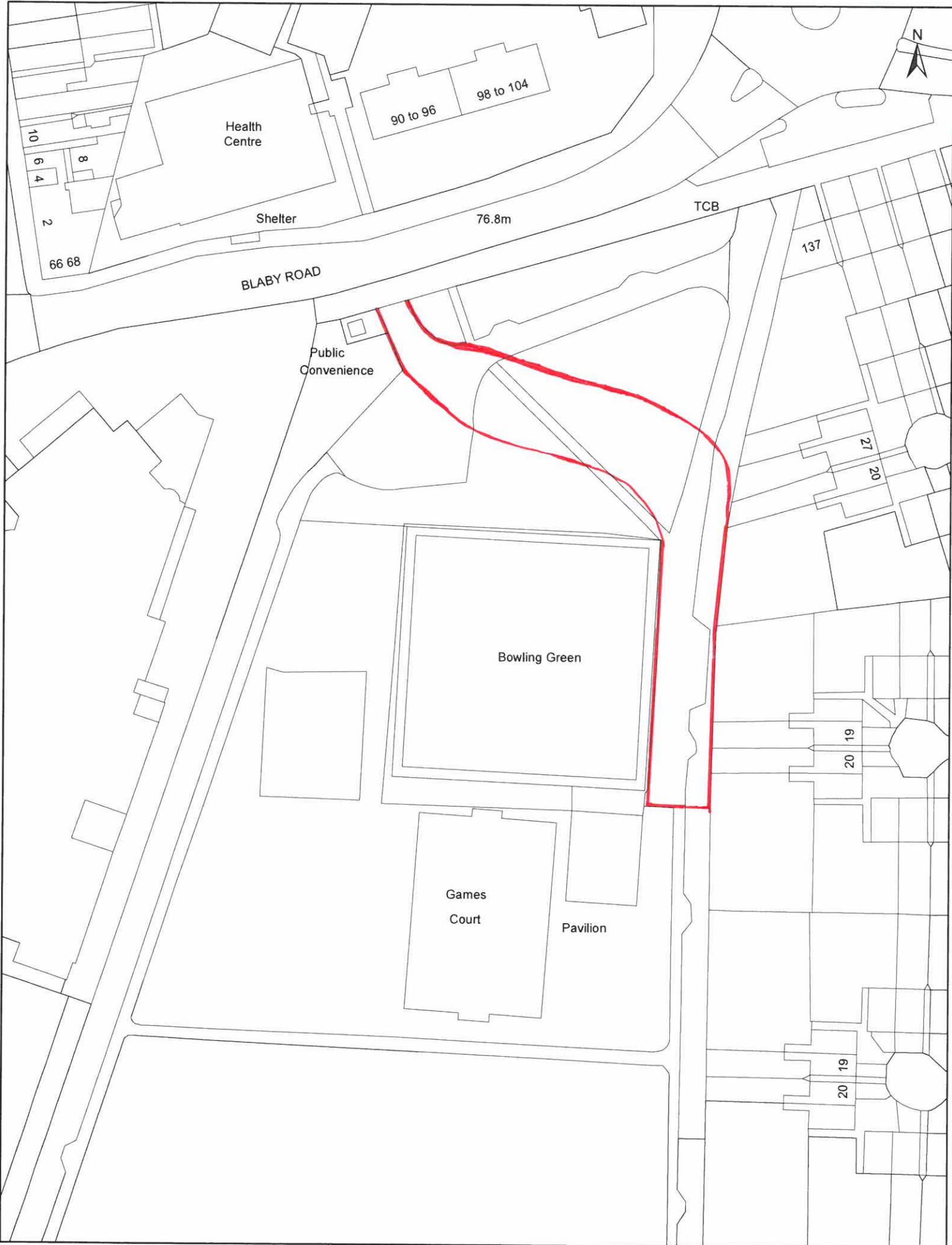

1:750

Brocks Hill Environment CentreCar Park

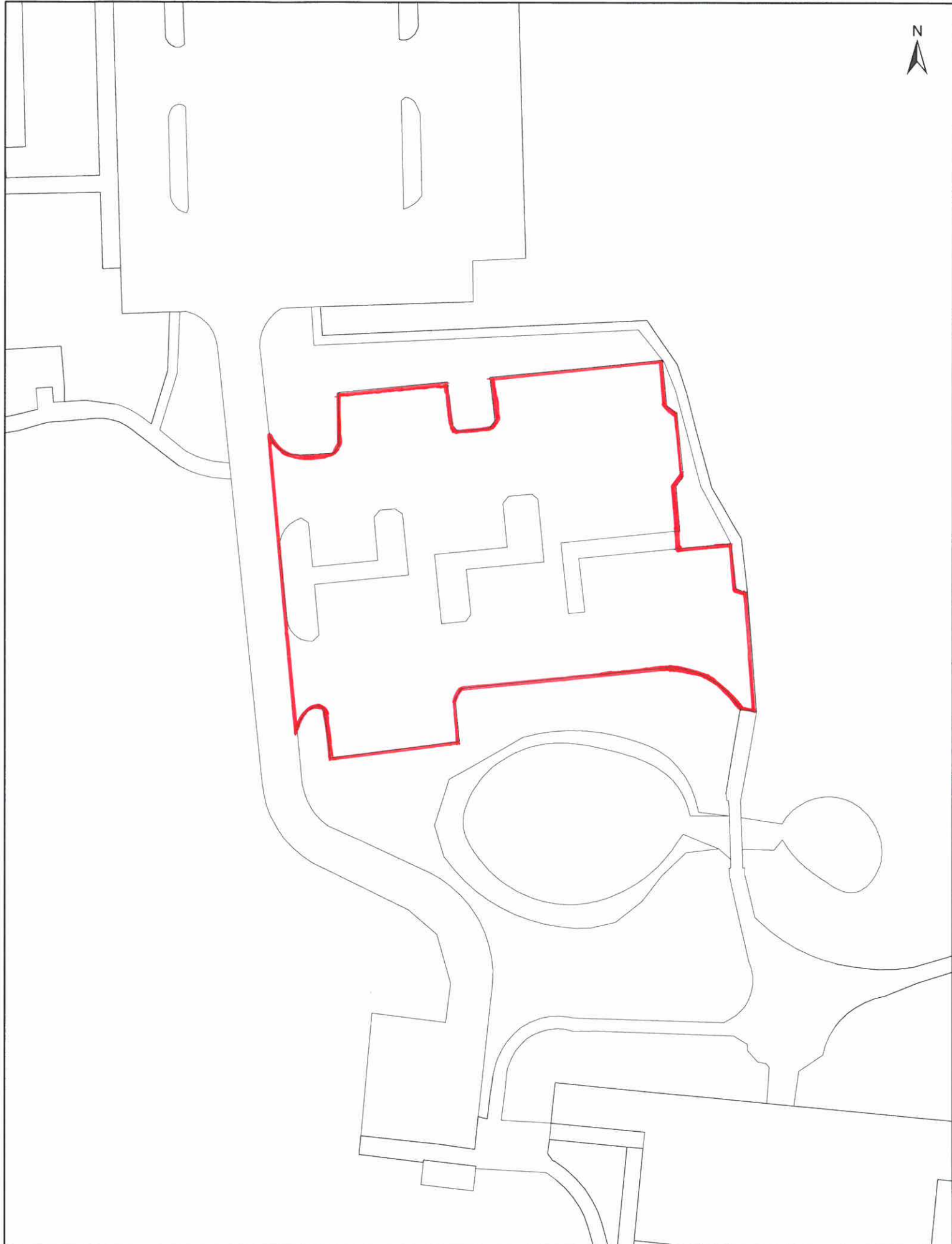

1:500

This map is based upon Ordnance Survey material with the permission of Ordnance Survey on behalf of the Controller of Her Majesty's Stationery Office. Crown copyright. Unauthorised reproduction infringes crown copyright and may lead to prosecution or civil proceedings. Oslicity & Weymouth Borough Council 2016. Licence No. 100022293

Coombe Park Car Park

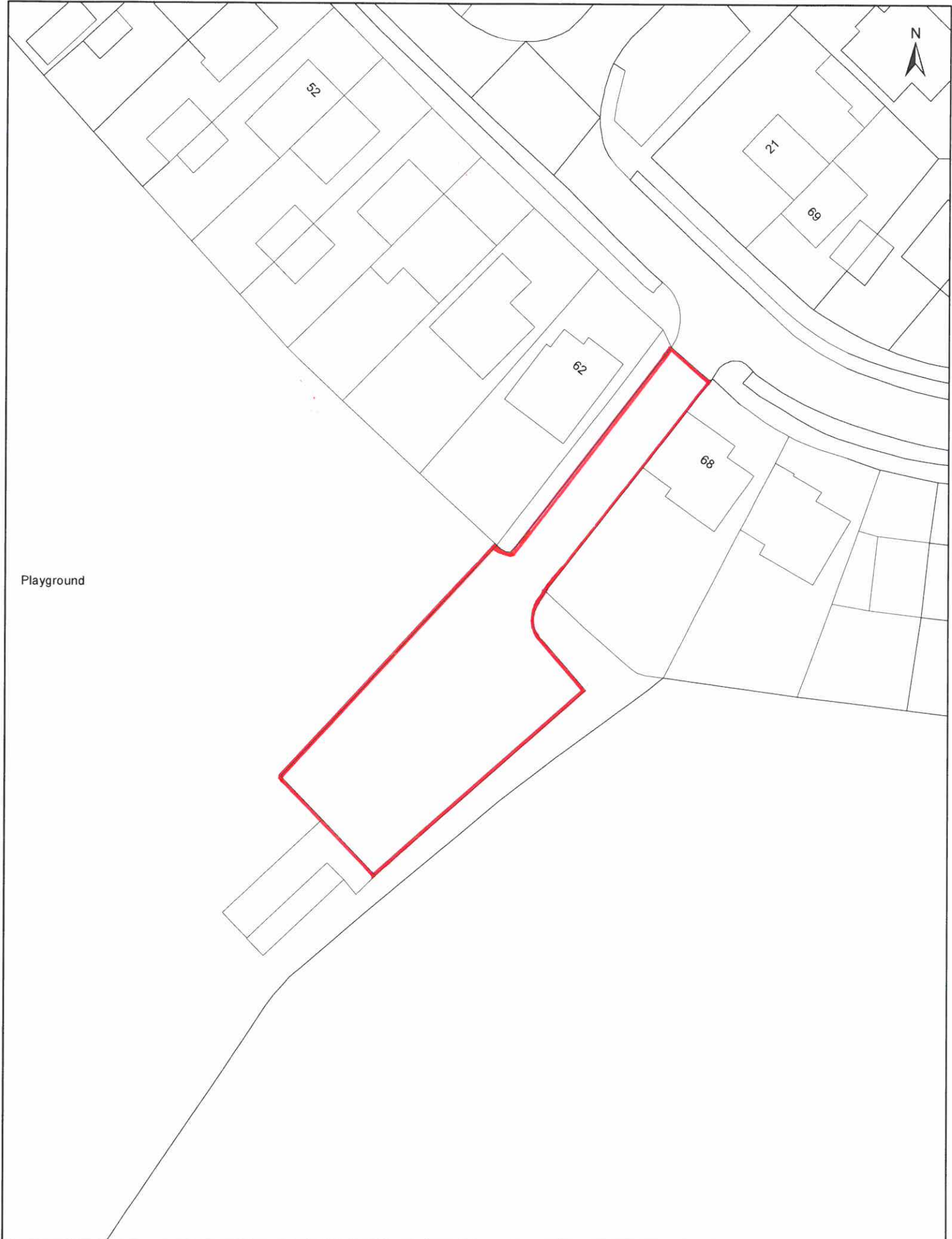

Council Offices Car Park



1:1,000

Countesthorpe Road Car Park

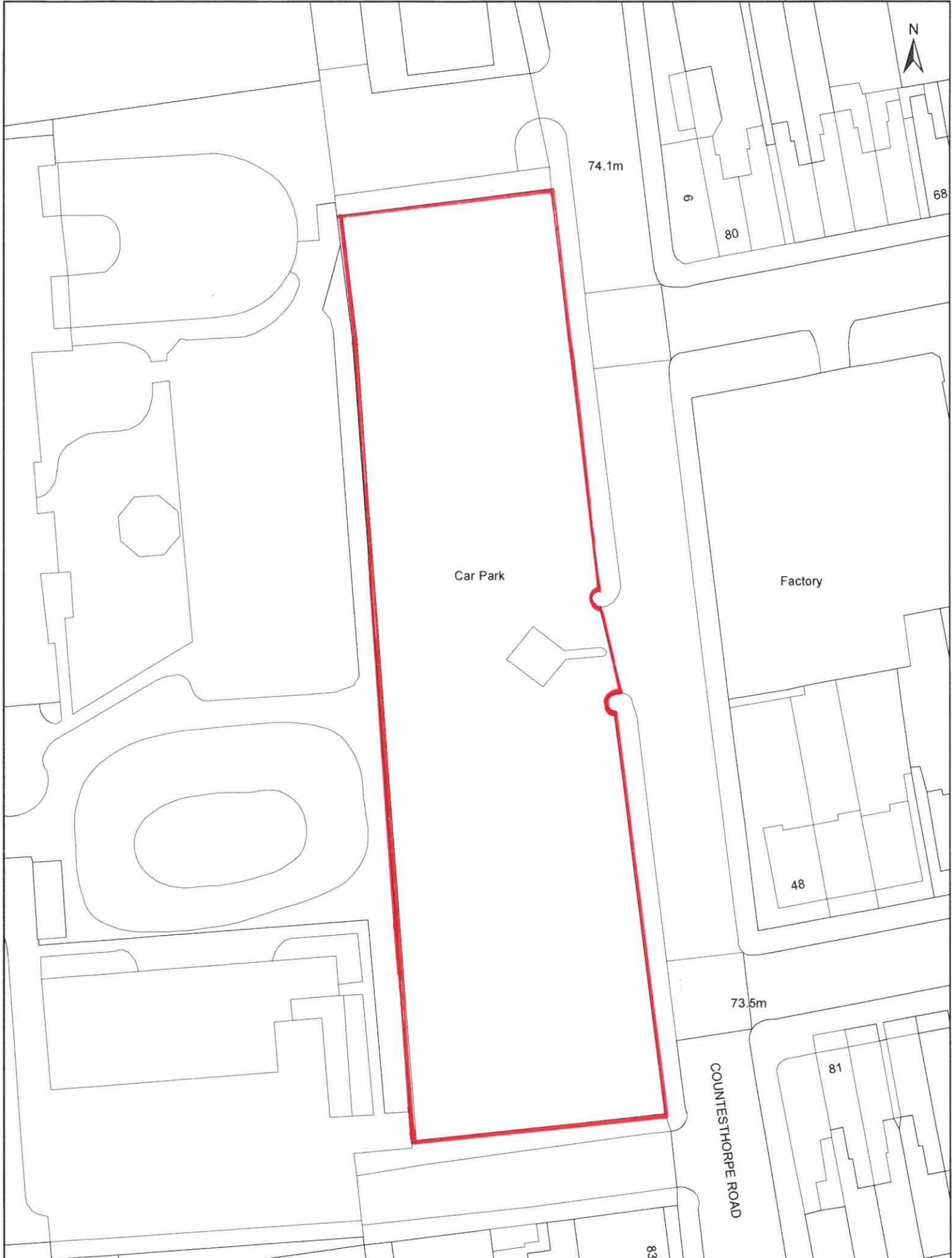

East Street Car Park

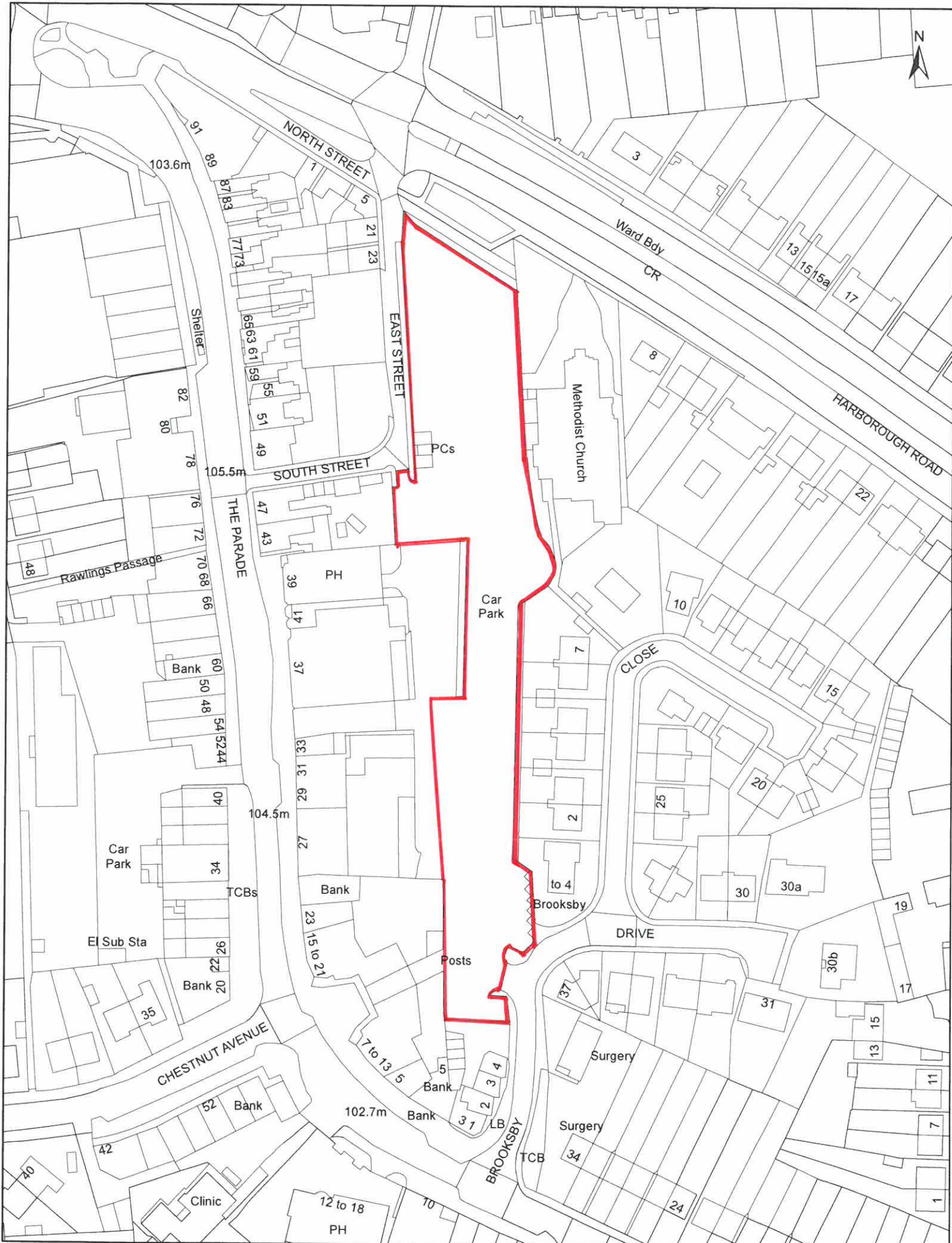

1:1,250

Ellis Park Car Park

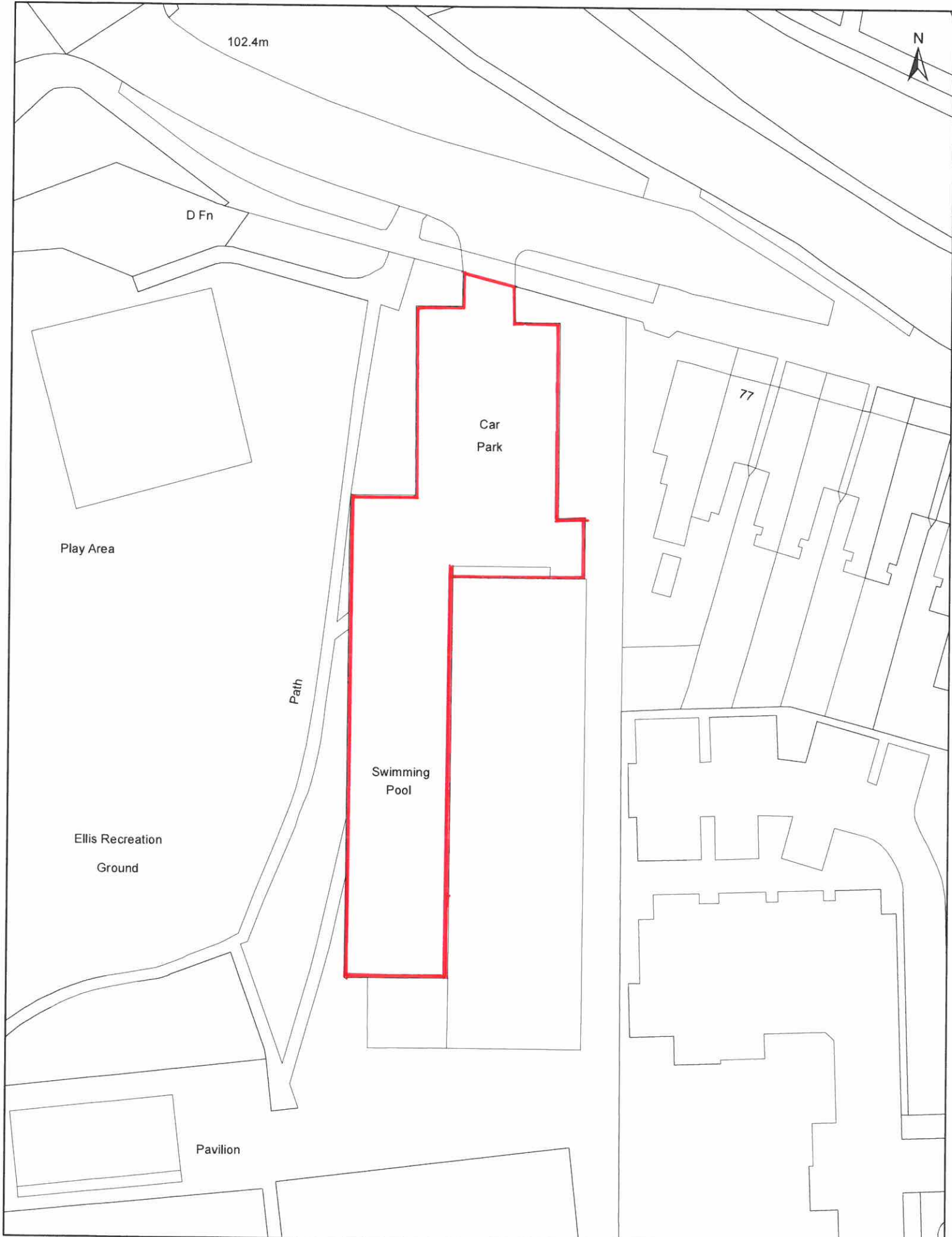

1:500

This map is based upon Ordnance Survey material with the permission of Ordnance Survey on behalf of the Controller of Her Majesty's Stationery Office. Crown copyright. Unauthorised reproduction infringes crown copyright and may lead to prosecution or civil proceedings. Dudley & Wignat Borough Council 2014. License No. 100023293

Frederick Street Car Park



Freer Community Centre Car Park

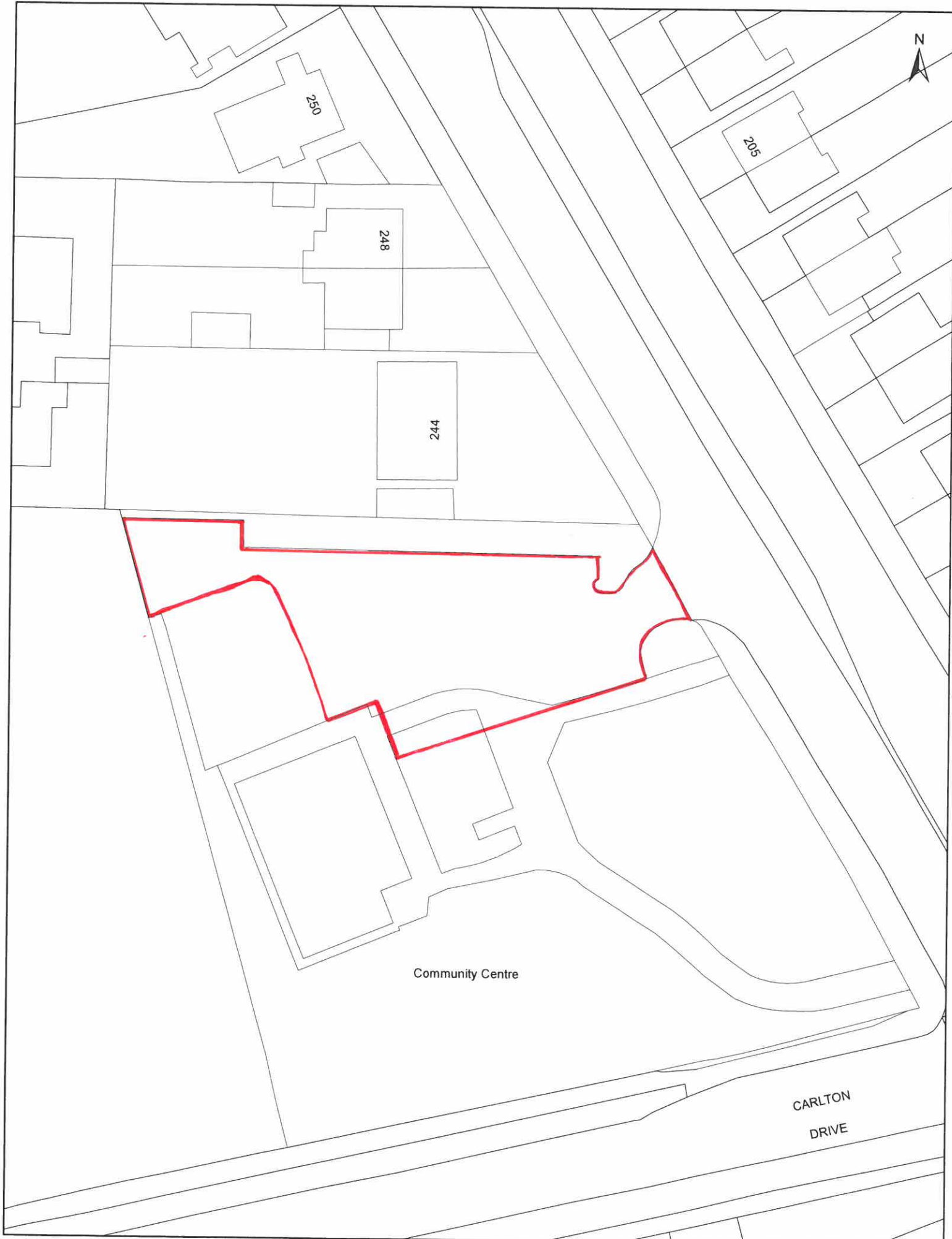

1:500

This map is based upon Ordnance Survey material with the permission of Ordnance Survey on behalf of the Controller of Her Majesty's Stationery Office: Crown copyright. Unauthorised reproduction infringes Crown copyright and may lead to prosecution or civil proceedings. Quality & Wigan Borough Council 2014. License No. 100021293

Horsewell Lane Park Car Park



Junction Road Car Park

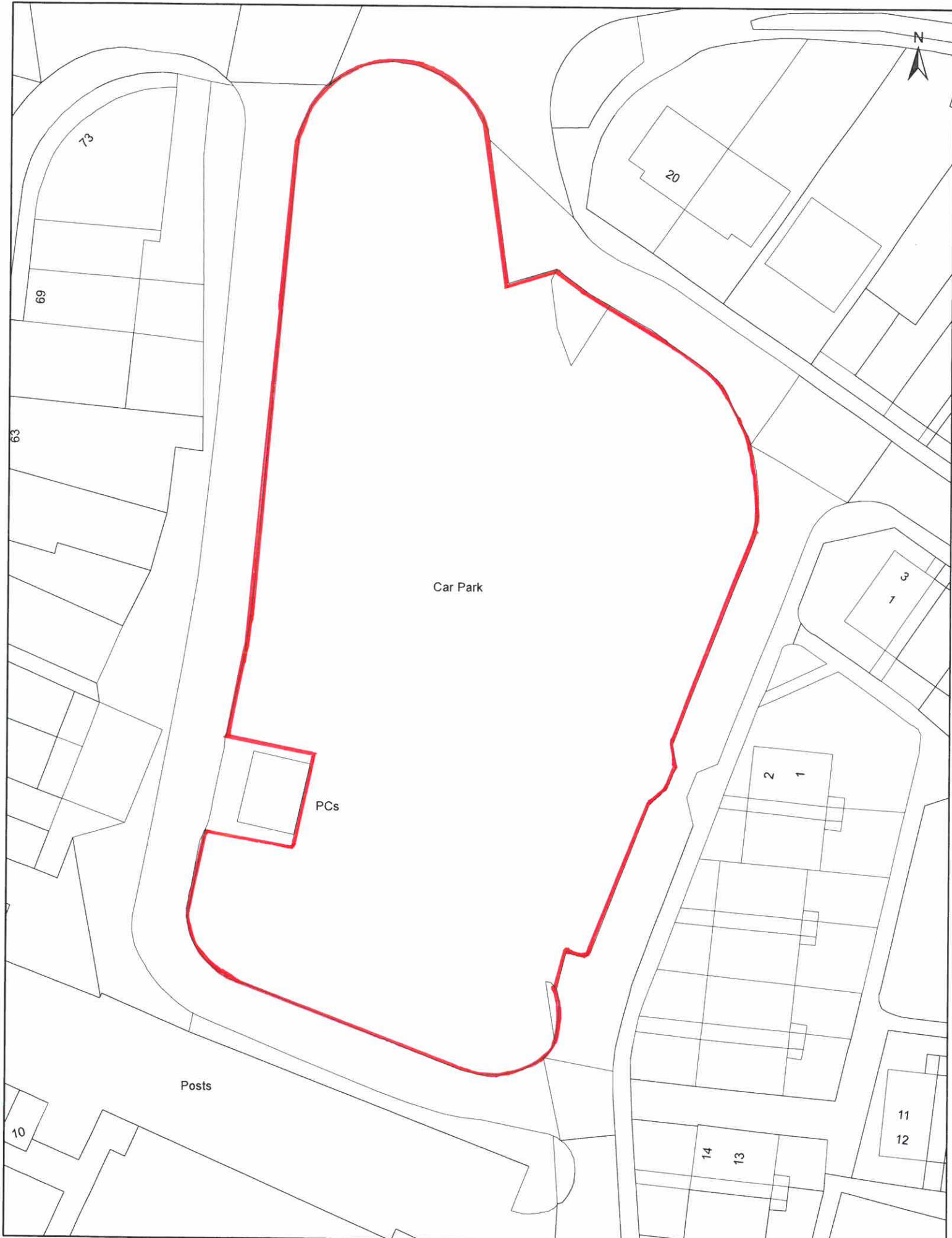

1:500

This map is based upon Ordnance Survey material with the permission of Ordnance Survey on behalf of the Controller of Her Majesty's Stationery Office. Crown copyright. Unauthorised reproduction infringes Crown copyright and may lead to prosecution or civil proceedings. © City & Wigan Borough Council 2014. Licence No. 100023293

Kirkdale Road Car Park

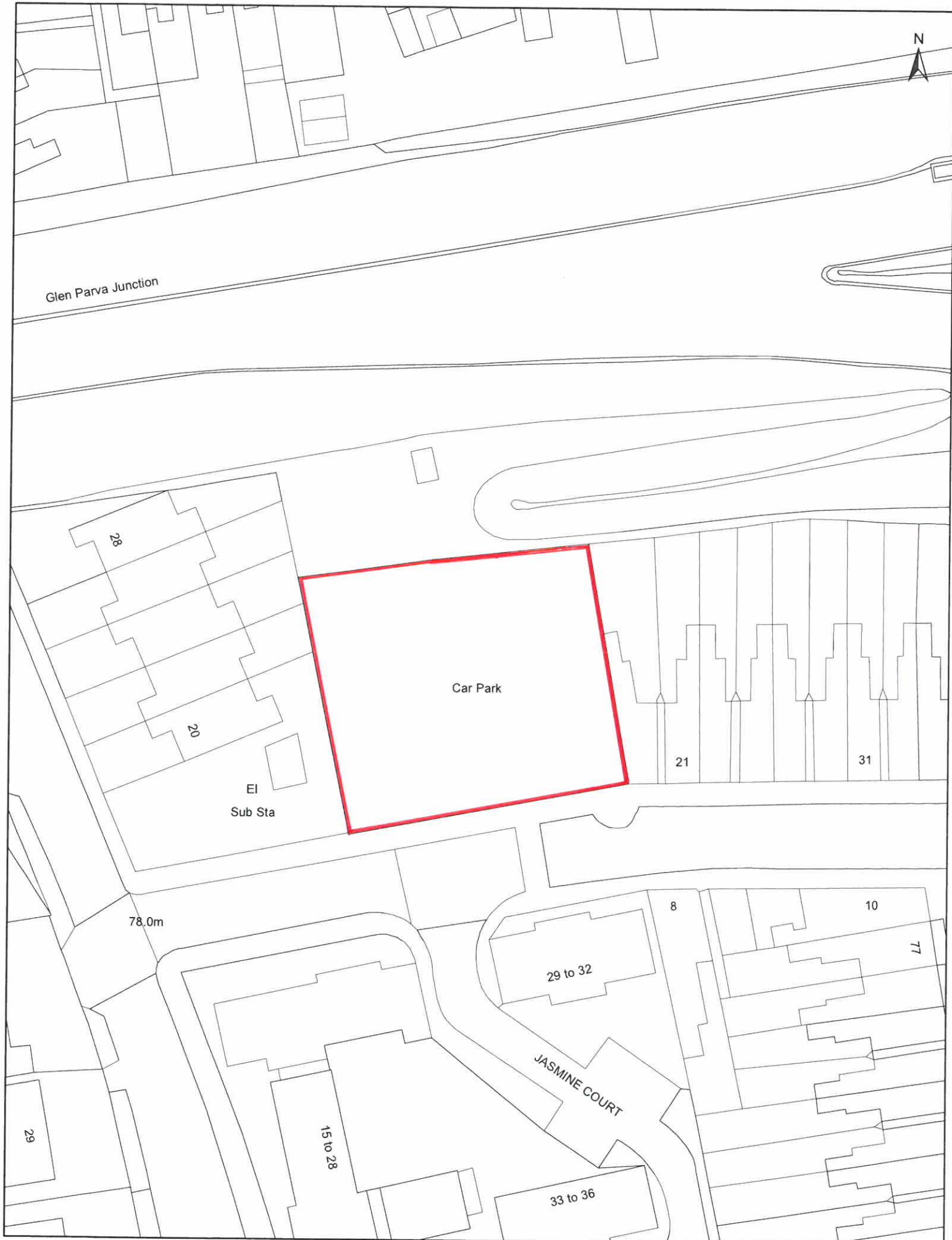

1:500

This map is based upon Ordnance Survey material with the permission of Ordnance Survey on behalf of the Controller of Her Majesty's Stationery Office. Crown copyright. Unauthorised reproduction infringes Crown copyright and may lead to prosecution or civil proceedings. Glosby & Wigton Borough Council 2014. License No. 100022293

Oadby Depot Car Park

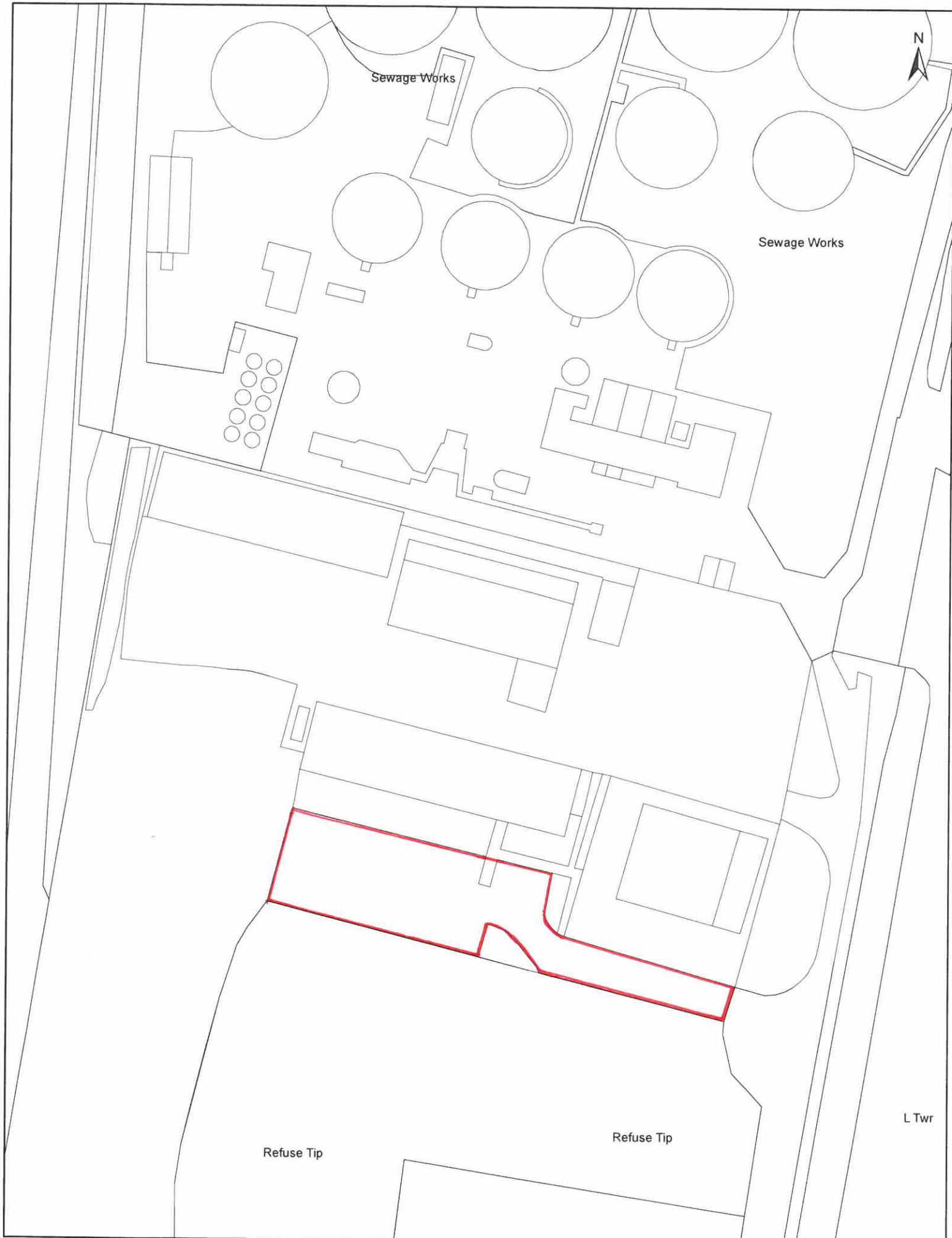

Paddock Street Car Park



Parklands Leisure Centre Car Park

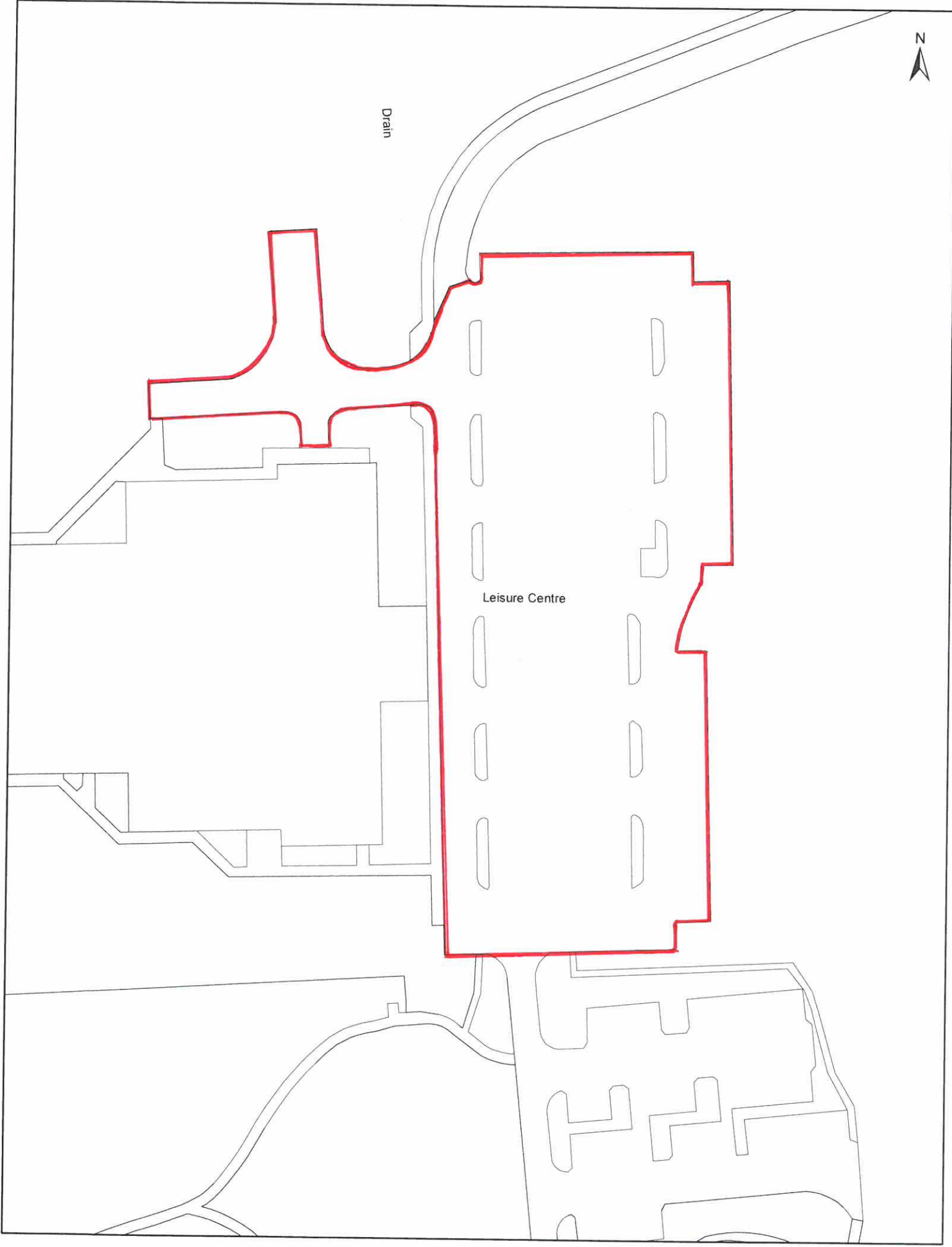

1:750

This map is based upon Ordnance Survey material with the permission of Ordnance Survey on behalf of the Controller of Her Majesty's Stationary Office. Crown copyright. Unauthorised reproduction infringes crown copyright and may lead to prosecution or civil proceedings. Orkney & Shetland Islands Council 2014. Licence No. 10001205

Peace Memorial Park Car Park

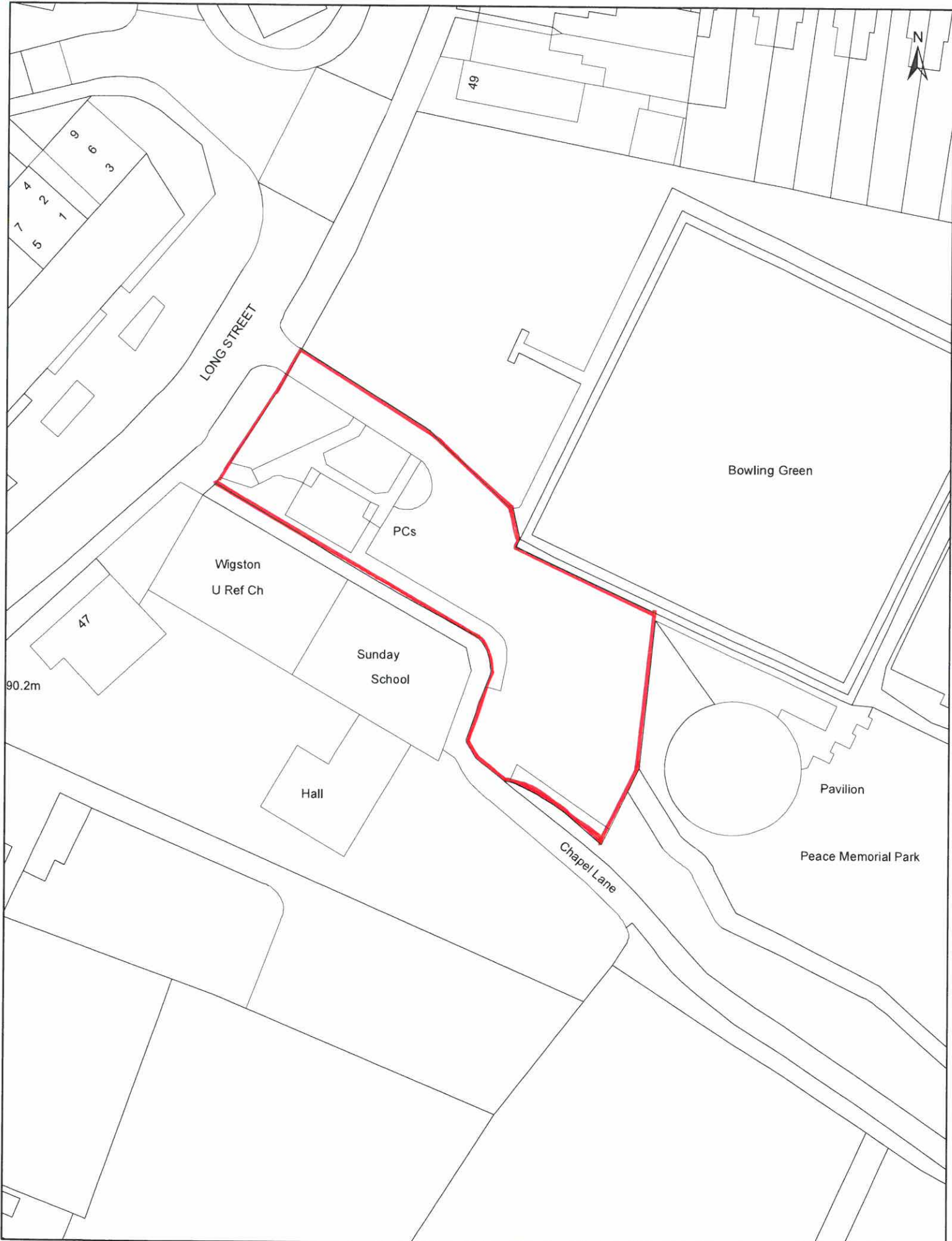

St Peters Church Hall Car Park

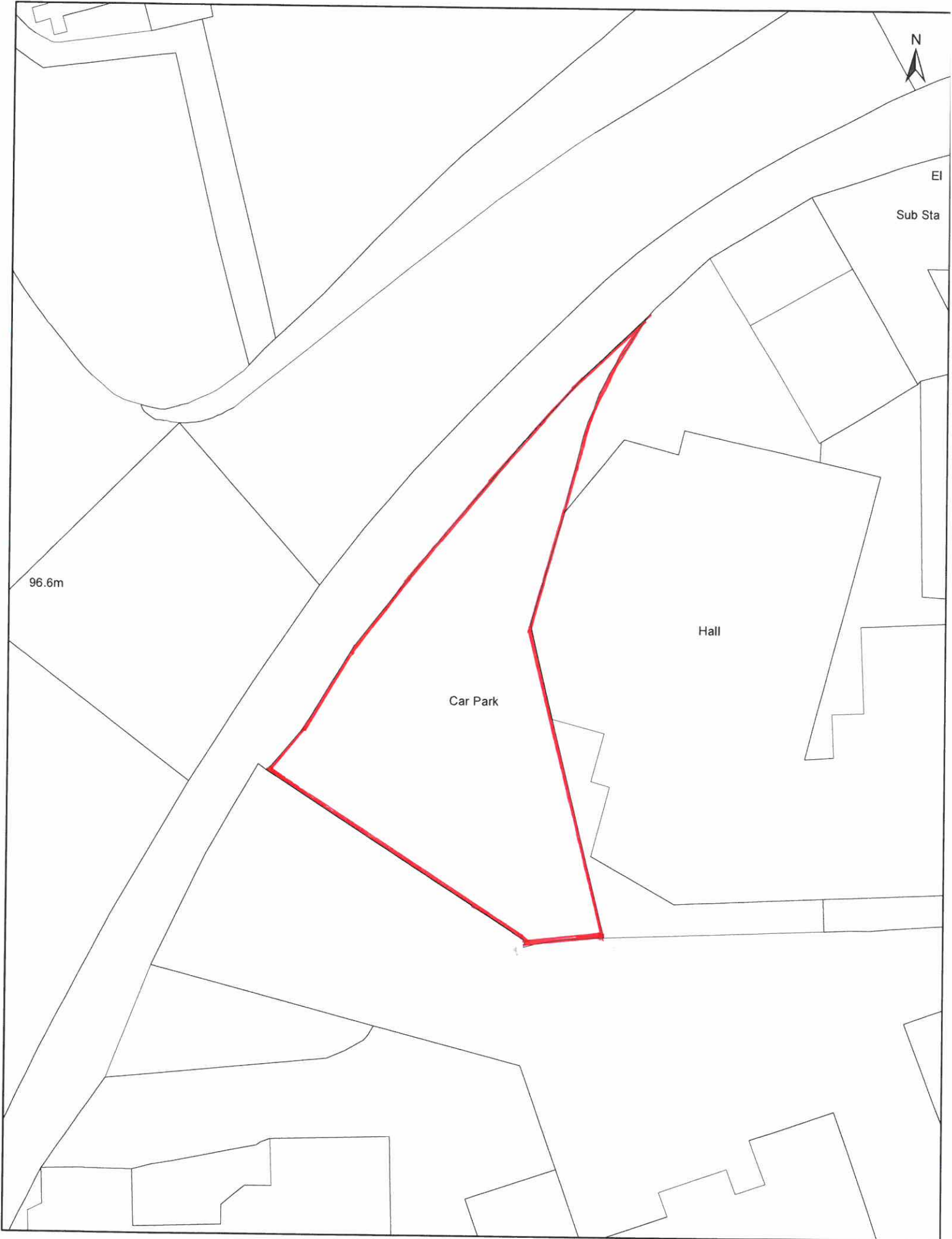

Sandhurst Street Car Park

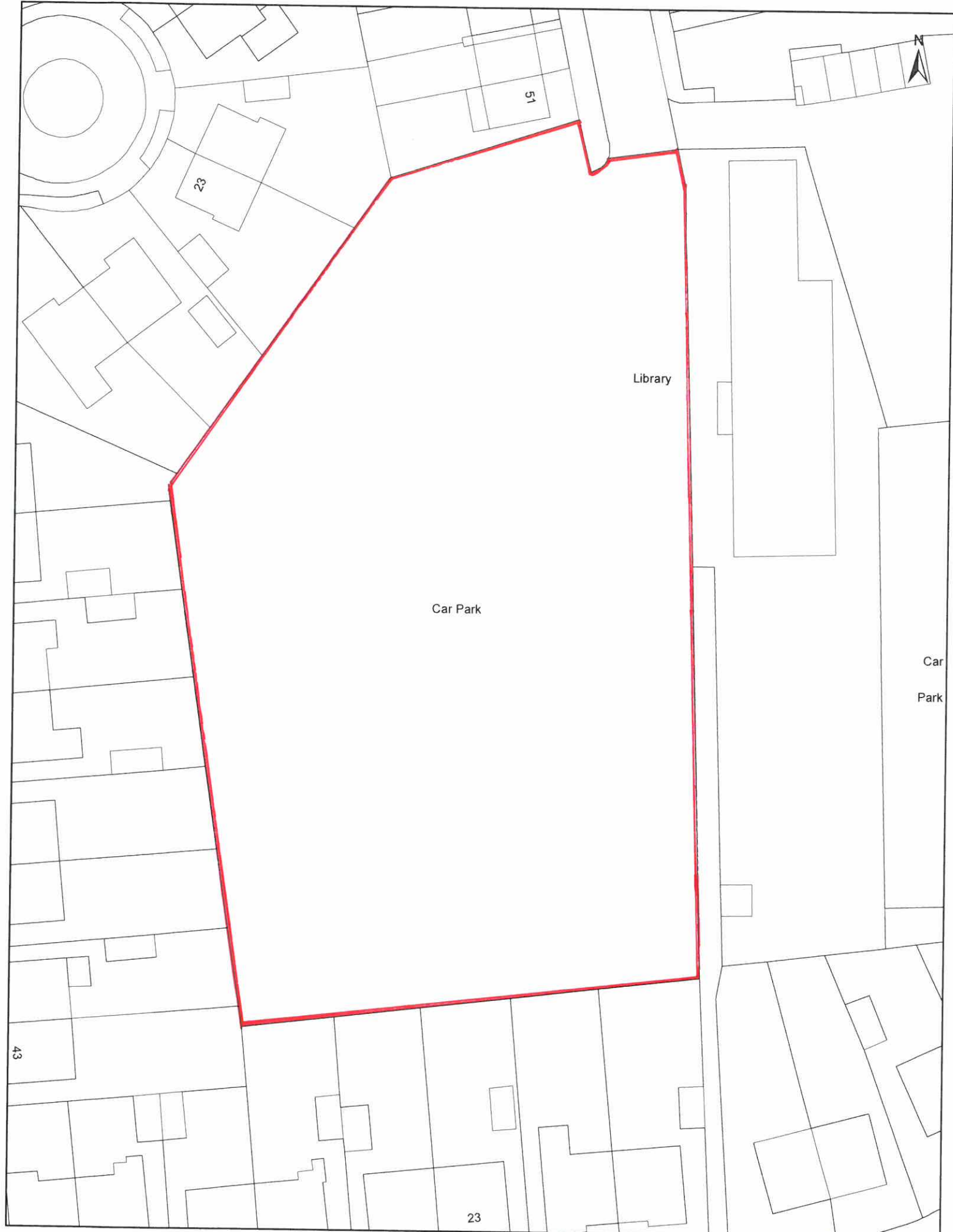

1:500

This map is based upon Ordnance Survey material with the permission of Ordnance Survey on behalf of the Controller of Her Majesty's Stationary Office. Crown copyright. Unauthorised reproduction infringes crown copyright and may lead to prosecution or civil proceedings. Gellie & Wigston Borough Council 2014. Licence No. 100022952

Spring Lane Car Park

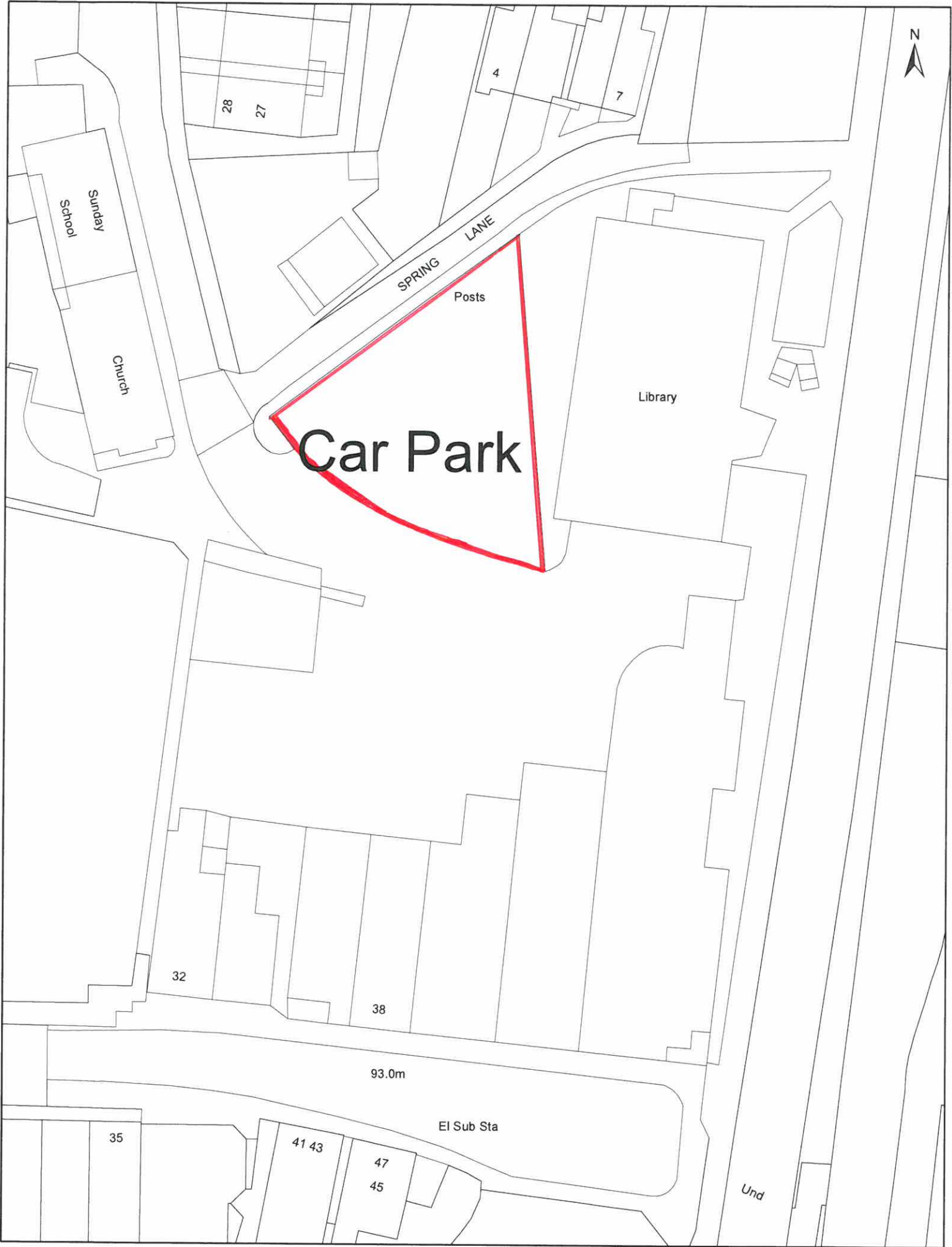

1:500

This map is based upon Ordnance Survey material with the permission of Ordnance Survey on behalf of the Controller of Her Majesty's Stationery Office. Crown copyright. Unauthorised reproduction infringes crown copyright and may lead to prosecution or civil proceedings. Orkney & Shetland Council 2014. Licence No. 100022292

Station Street Car Park

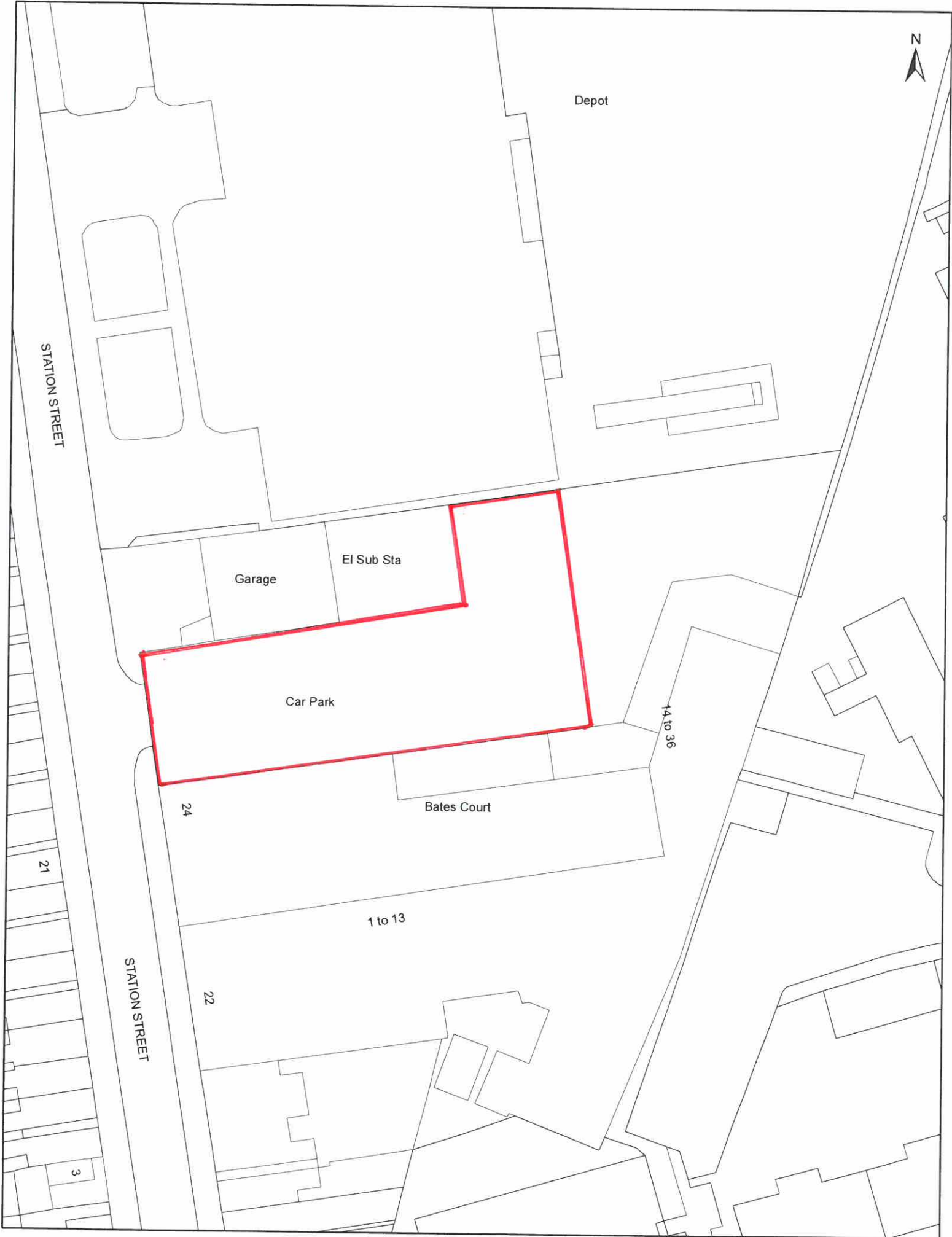

1:500

This map is based upon Ordnance Survey material with the permission of Ordnance Survey on behalf of the Controller of Her Majesty's Stationery Office. Crown copyright. Unauthorised reproduction infringes crown copyright and may lead to prosecution or civil proceedings. Derby & Wigan Borough Council 2014. License No. 100022292

Uplands Park Car Park

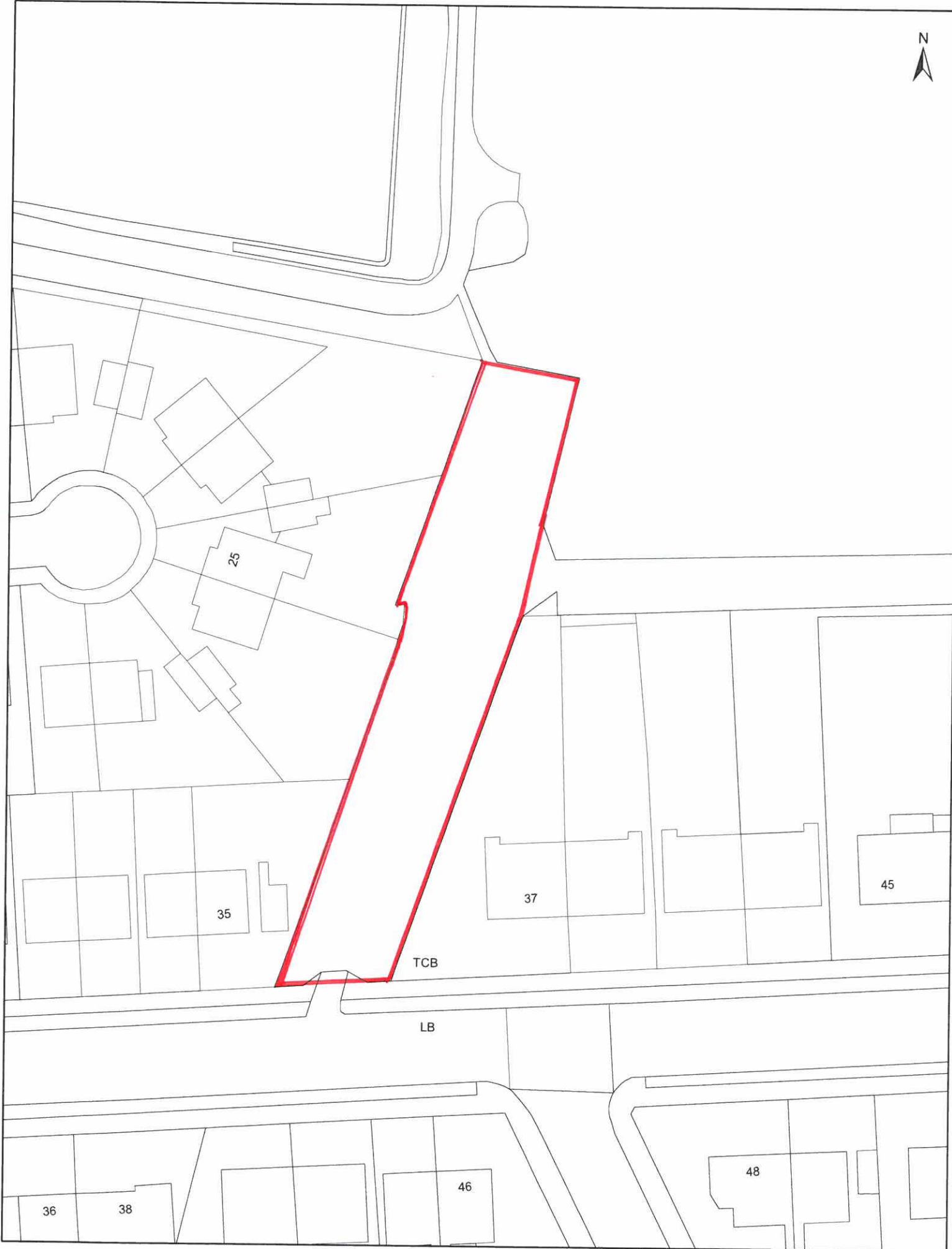

1:500

This map is based upon Ordnance Survey material with the permission of Ordnance Survey on behalf of the Controller of Her Majesty's Stationary Office. Crown copyright. Unauthorised reproduction infringes Crown copyright and may lead to prosecution or civil proceedings. Leeds & Wetherill Borough Council 2014. Licence No. 100023293

Walter Charles Centre Car Park



Wigston Cemetery Car Park

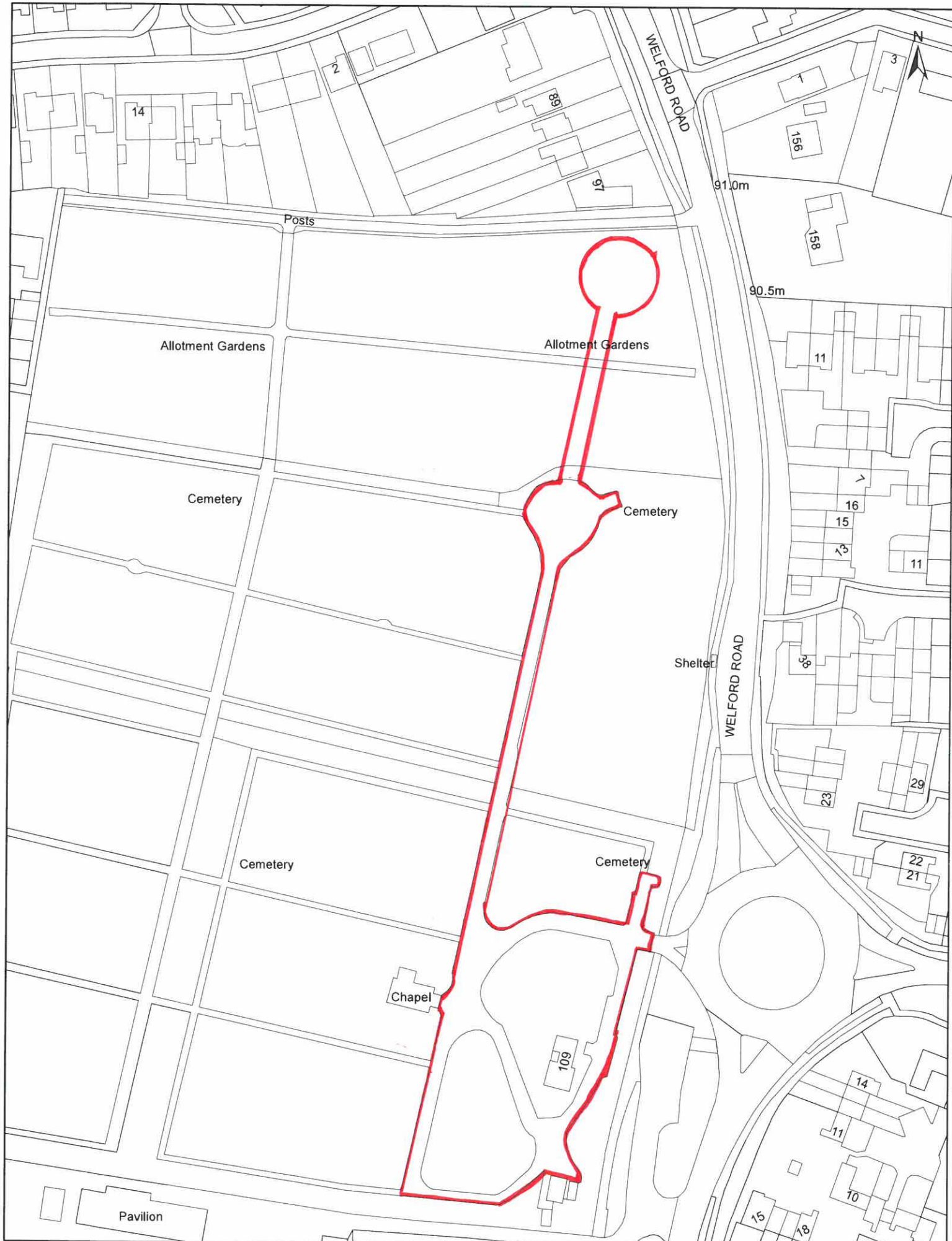

1:1,250

Wigston Swimming Pool Car Park

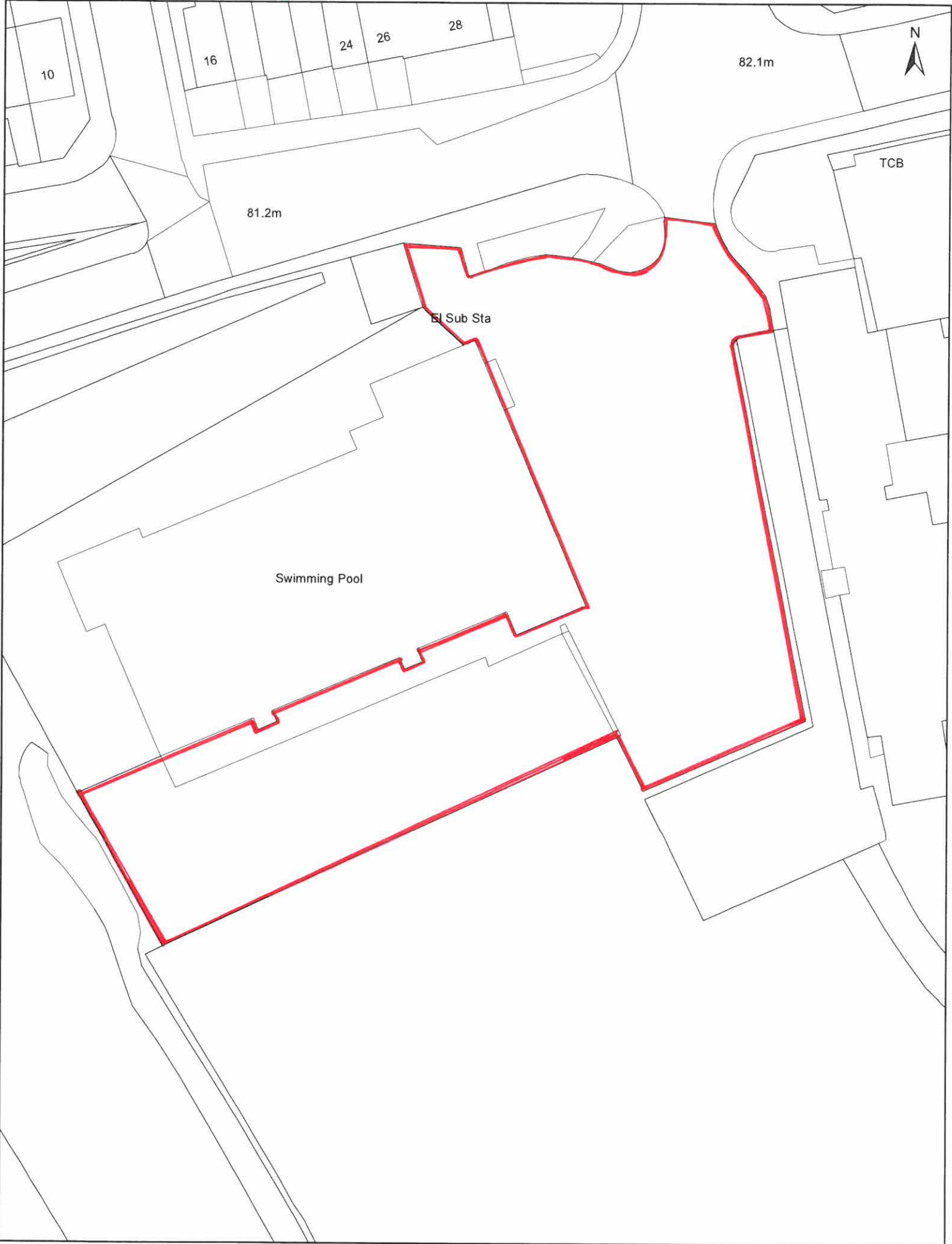

Willow Park Car Park

